

Welcome to Imperial Hotel

We're so glad you're here. We have implemented a number of new systems to help keep you and our team as safe as possible. We would be very grateful for your co-operation to help us all stay safe and well.

Please use the hand sanitisers found throughout the hotel on entering and exiting the building, on calling the lift, and frequently during your stay.

We've implemented a clockwise one-way system on the upper ground floor for access to the main public areas. It may seem a little strange at first. Please respect social distancing and follow the signs and guidance given.

Please use the South Stairs (nearest Reception) to go up to your room.

Please use the North Stairs to come down.

Signage near your bedroom will point the way.

Please be patient on the stairs and in bedroom corridors, and avoid passing anyone who is not a member of your household.

If you can, please avoid using the lift. The lift should only be shared with someone from your household.

We'd like to keep the loos on the upper ground floor for use by restaurant guests only if possible. Please use the toilet in your bedroom when in the hotel.

We will be cleaning all touch points regularly, but please remember to wash your hands thoroughly and frequently throughout the day.

Covid-19 has rocked the world as we know it, and sadly necessitates significant changes to our usual levels of hospitality. Please rest assured that the welcome is as warm as ever. We are delighted to see you and very much hope you will relax, enjoy yourself, and come back soon.

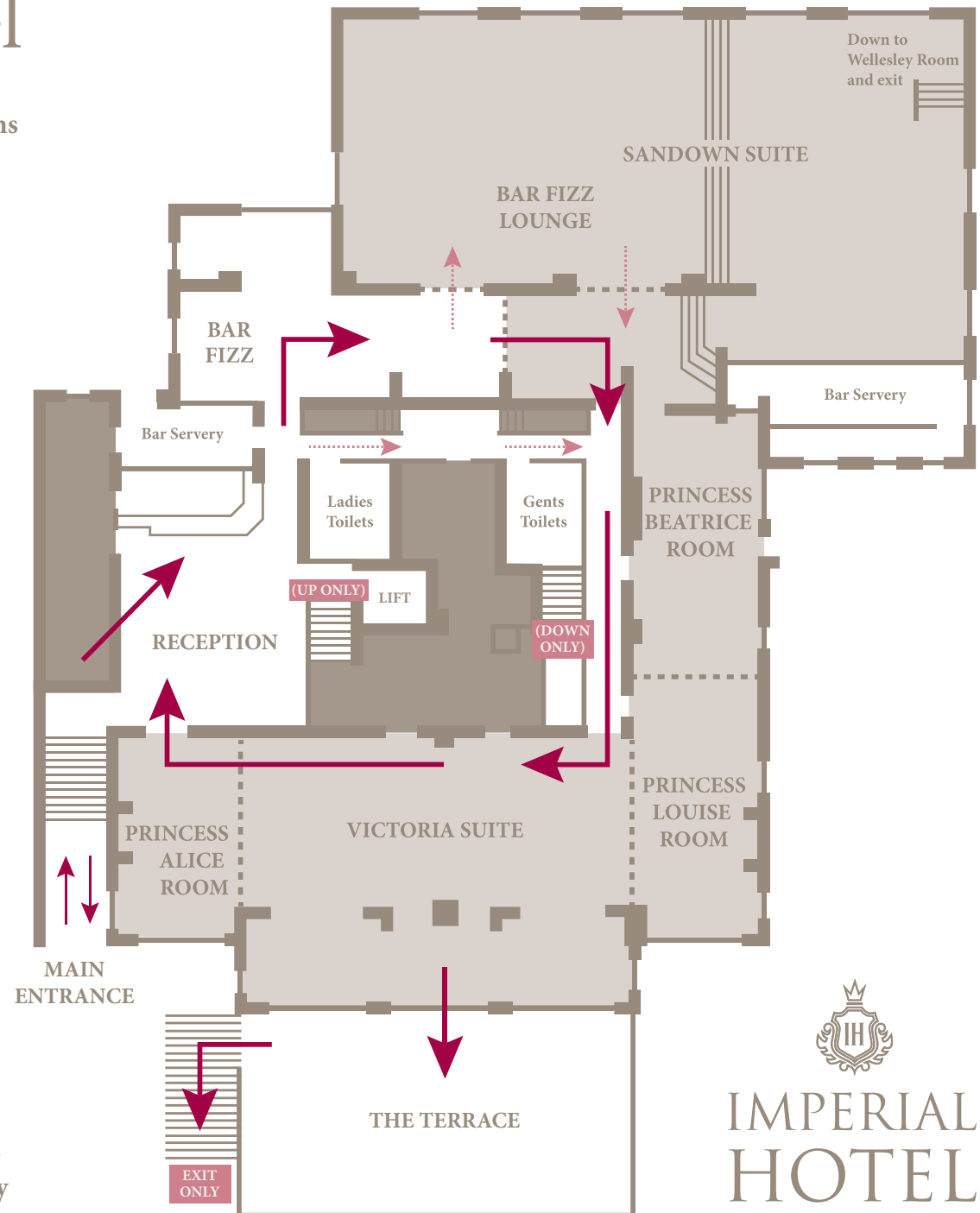

IMPERIAL
HOTEL
GREAT YARMOUTH